

PART B - NOT PART OF STADIUM
PUD SUBMISSION, DESIGN INTENT
SHOWN FOR REFERENCE ONLY

PUBLIC REALM - NOT PART OF PUD
SUBMISSION, DESIGN INTENT SHOWN
FOR REFERENCE ONLY

DISTRICT OF COLUMBIA RESPONSIBLE
FOR DESIGN OF PUBLIC REALM

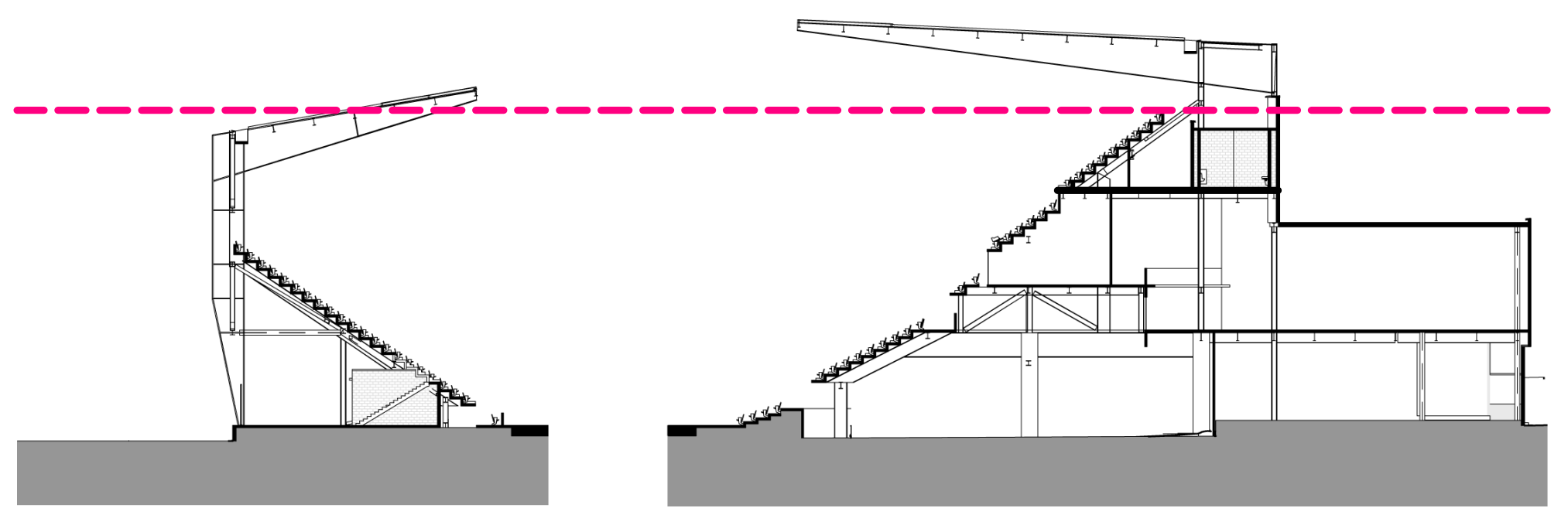
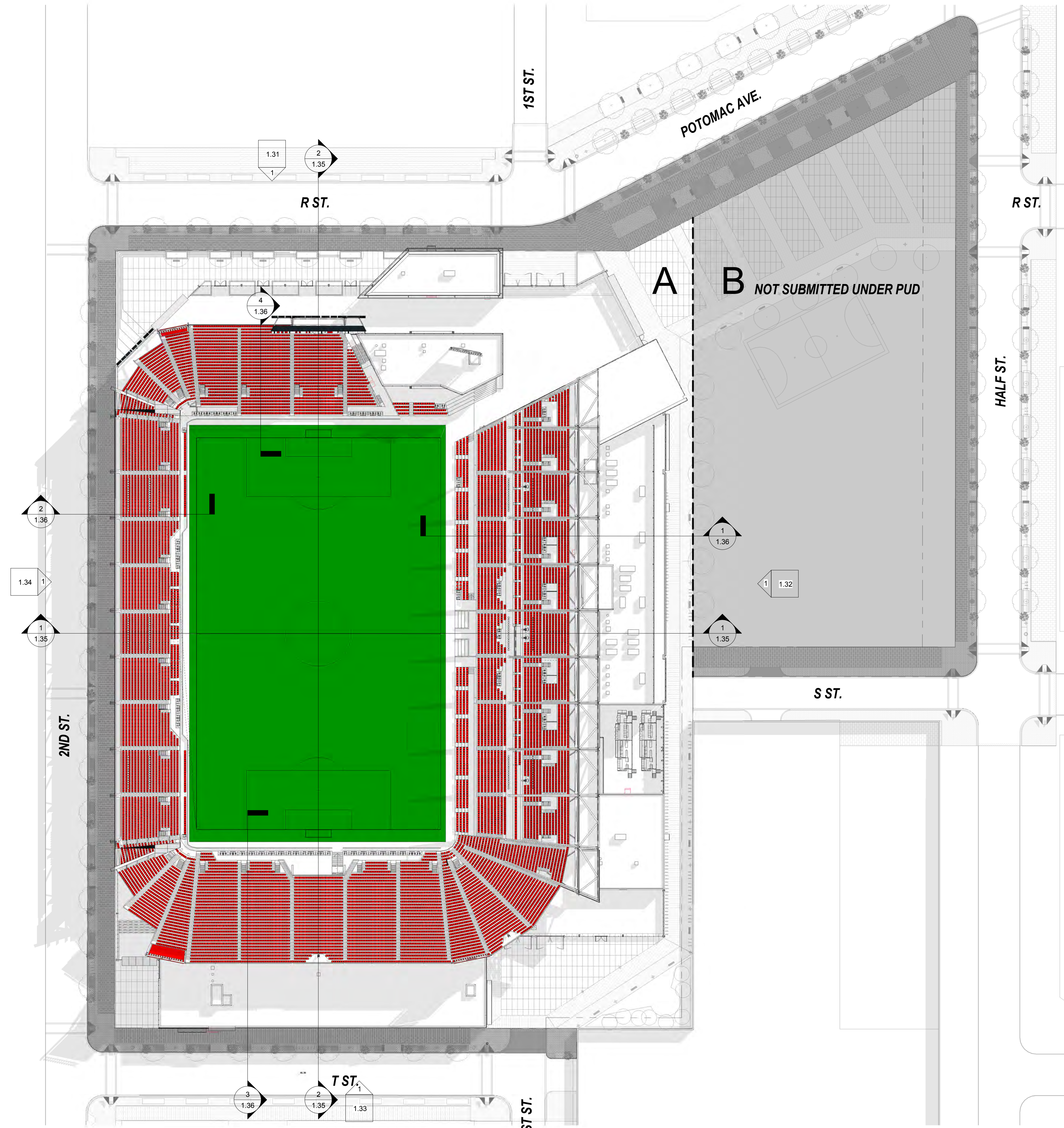

0 50' 100'

1 SEATING BOWL PLAN
1" = 50'-0"

INTERIOR LAYOUTS ARE ILLUSTRATIVE ONLY AND SUBJECT TO CHANGE ON FINAL PLAN

POPULOUS
Marshall Moya Design



DC UNITED SOCCER STADIUM
100 Potomac Avenue, SW
Washington, DC 20024

100% PUD SUBMISSION

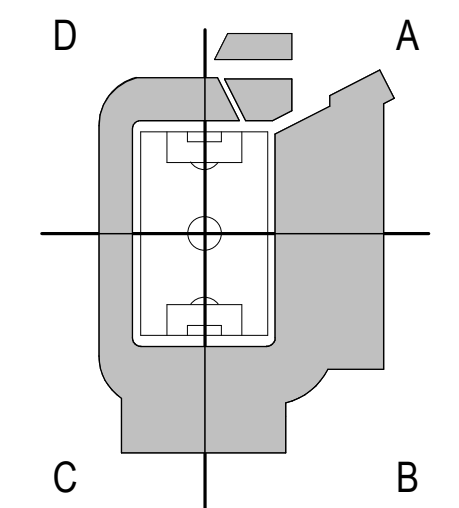

REF PLAN - SEATING
BOWL PLAN

PART B - NOT PART OF STADIUM
PUD SUBMISSION, DESIGN INTENT
SHOWN FOR REFERENCE ONLY

PUBLIC REALM - NOT PART OF PUD
SUBMISSION, DESIGN INTENT SHOWN
FOR REFERENCE ONLY

DISTRICT OF COLUMBIA RESPONSIBLE
FOR DESIGN OF PUBLIC REALM

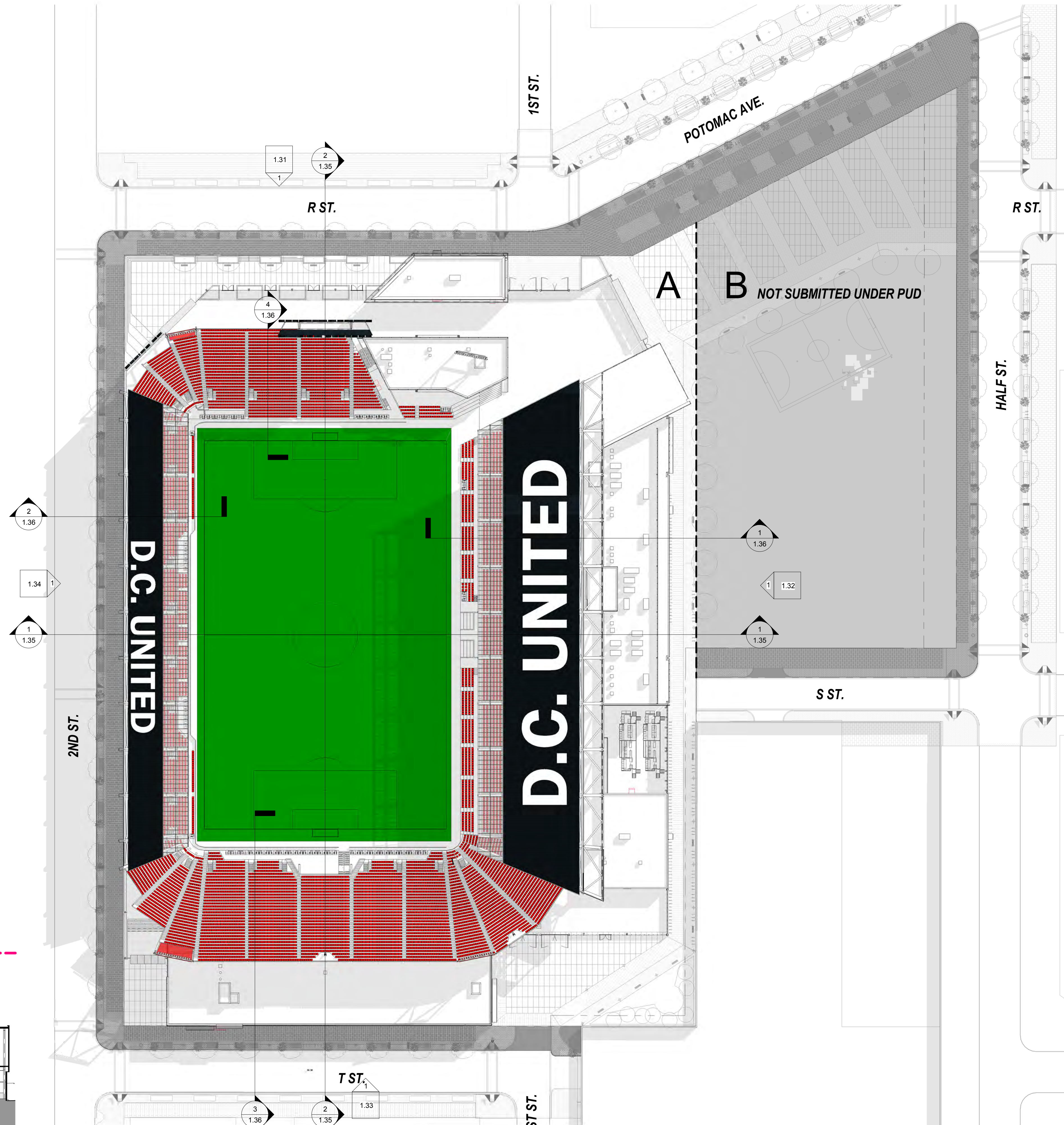

D.C. UNITED

D.C. UNITED

NOT SUBMITTED UNDER PUD

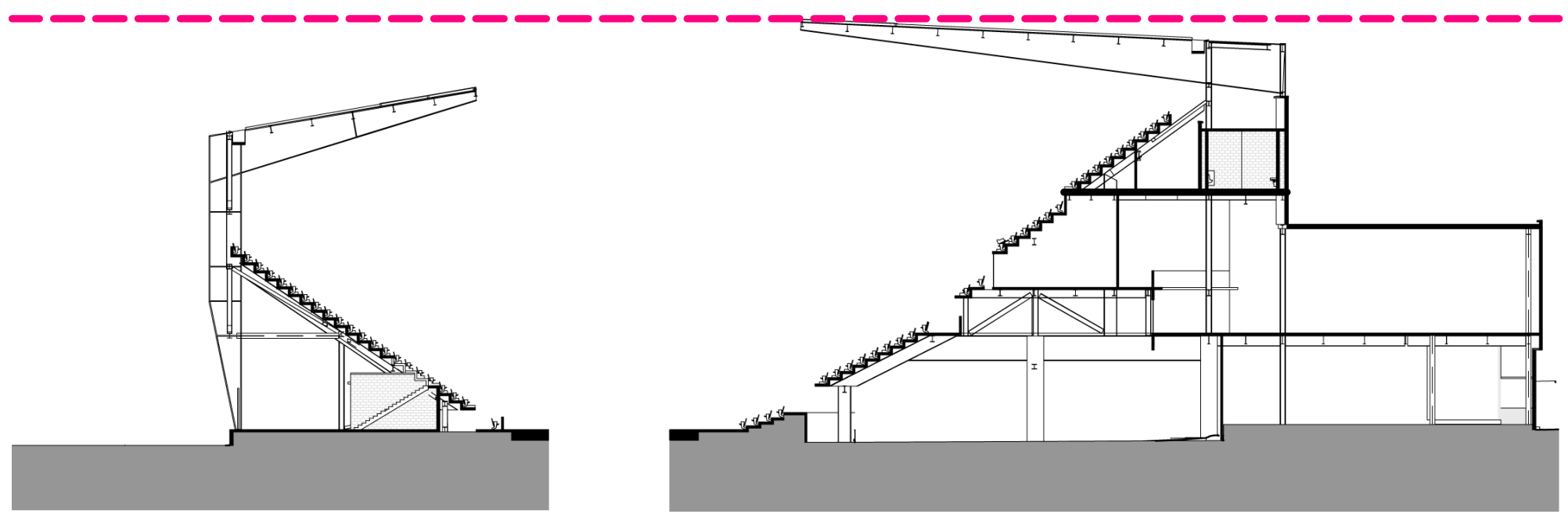

WEST SECTION

EAST SECTION

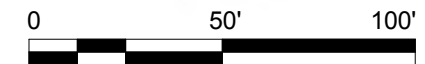

1 ROOF PLAN
1" = 50'-0"

INTERIOR LAYOUTS ARE ILLUSTRATIVE ONLY AND SUBJECT TO CHANGE ON FINAL PLAN

POPULOUS
Marshall Moya Design



DC UNITED SOCCER STADIUM
100 Potomac Avenue, SW
Washington, DC 20024

100% PUD SUBMISSION

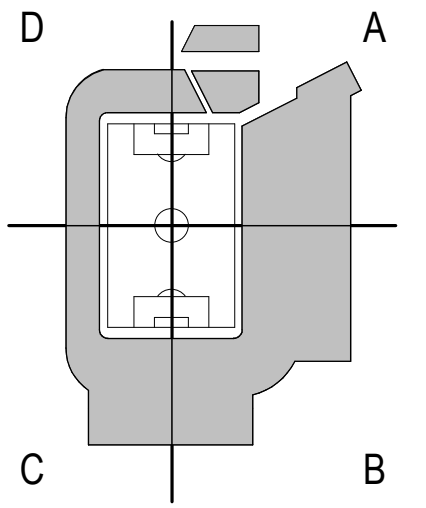

REF PLAN - ROOF PLAN

1.20



**TO DATE:
DC UNITED HAS SECURED
3,400 PARKING SPACES**

**D.C.
UNITED
STADIUM**



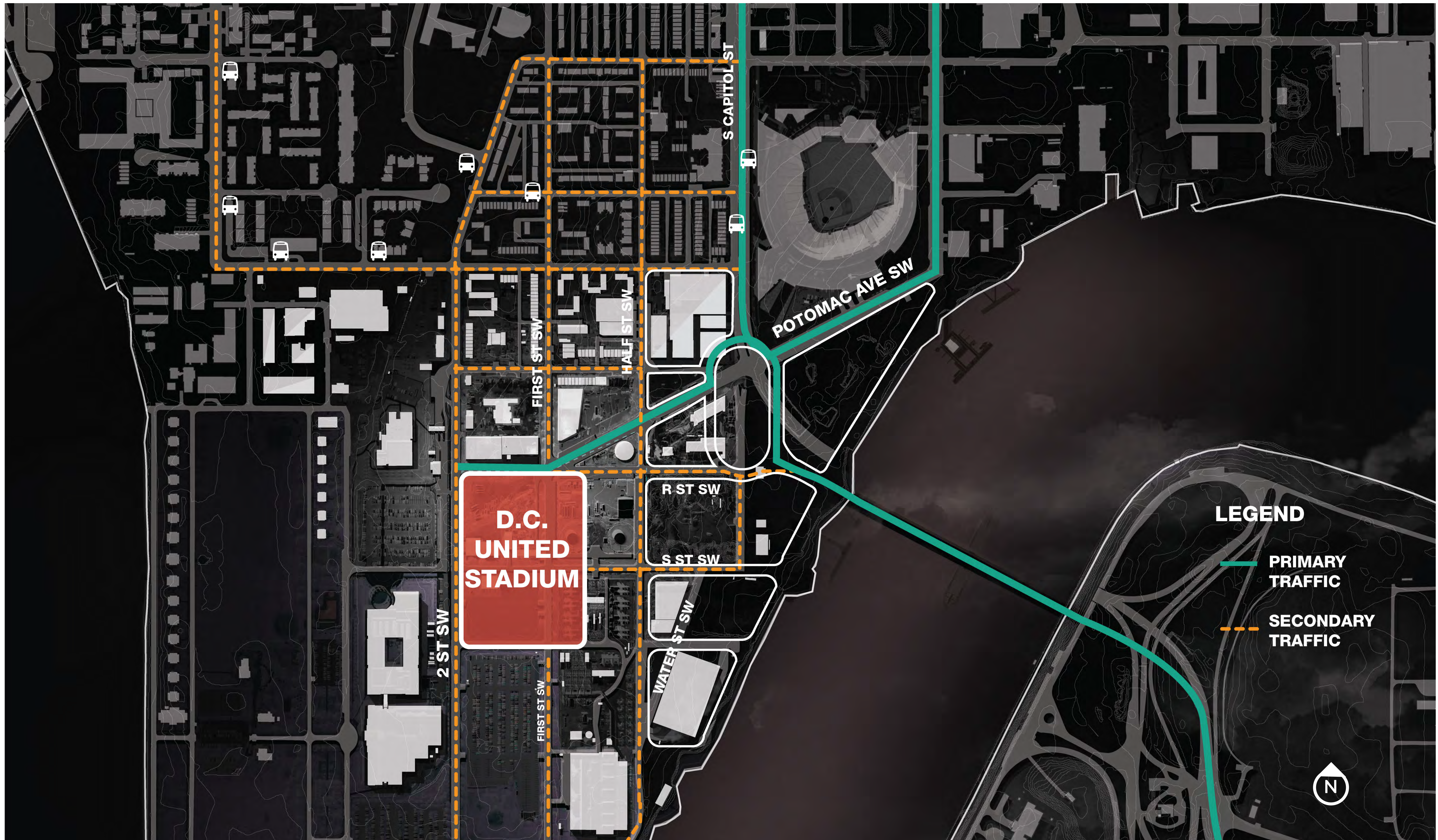

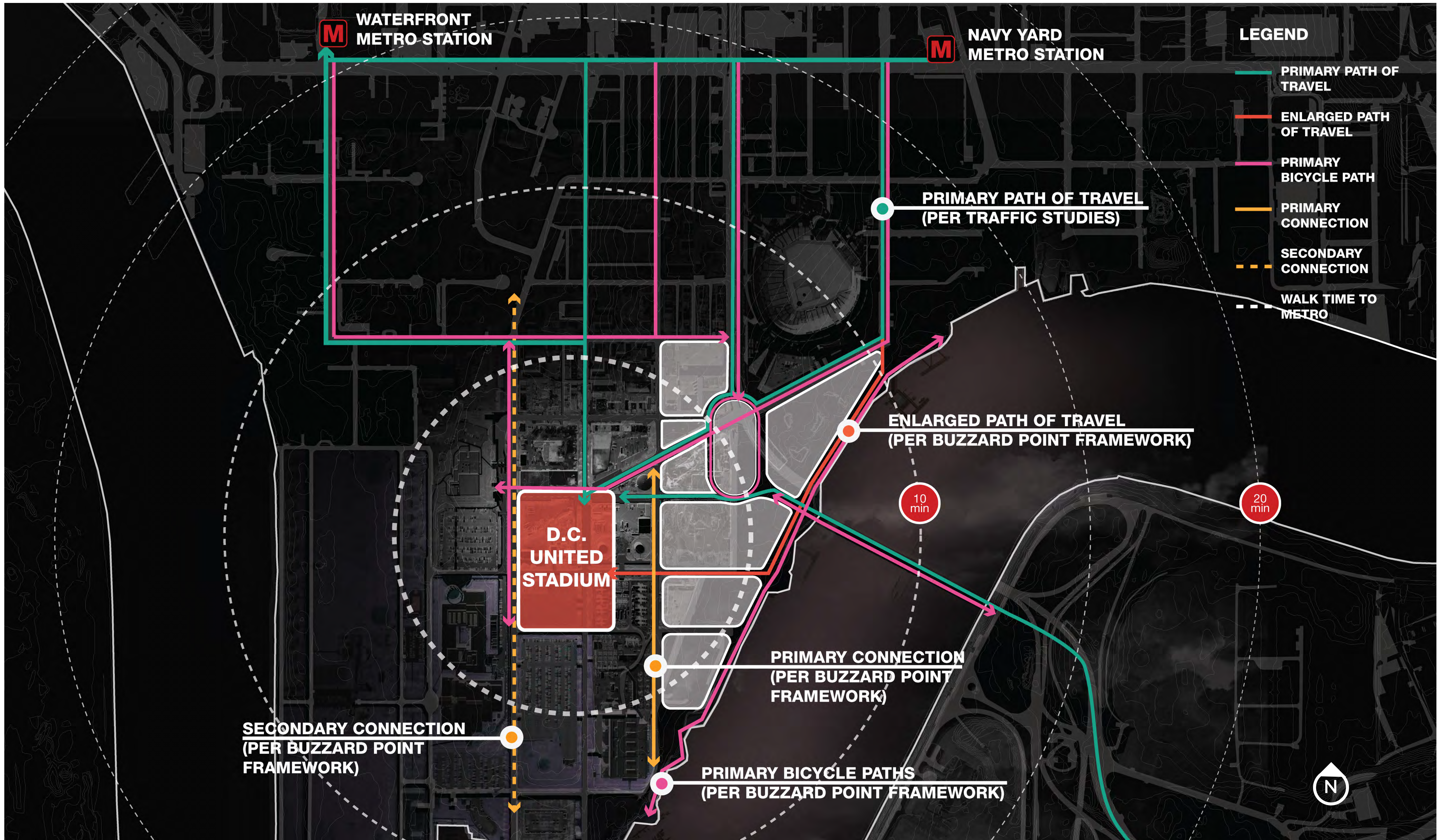

NORTH TO SOUTH PEDESTRIAN & BICYCLIST CONNECTION



PRIMARY BICYCLE PATHS PER GOROVE/SLADE TRAFFIC STUDY



PRIMARY PEDESTRIAN BOULEVARD PER BUZZARD POINT FRAMEWORK



PRIMARY PATH OF TRAVEL TO STADIUM



PRIMARY PATH OF TRAVEL AROUND STADIUM



FAN ENTRY POINTS BY PERCENTAGE



15%
2,910 FANS

75%
14,550 FANS

10%
1,940 FANS

PART B - NOT PART OF STADIUM PUD SUBMISSION, DESIGN INTENT SHOWN FOR REFERENCE ONLY

PUBLIC REALM - NOT PART OF PUD SUBMISSION, DESIGN INTENT SHOWN FOR REFERENCE ONLY

DISTRICT OF COLUMBIA RESPONSIBLE FOR DESIGN OF PUBLIC REALM

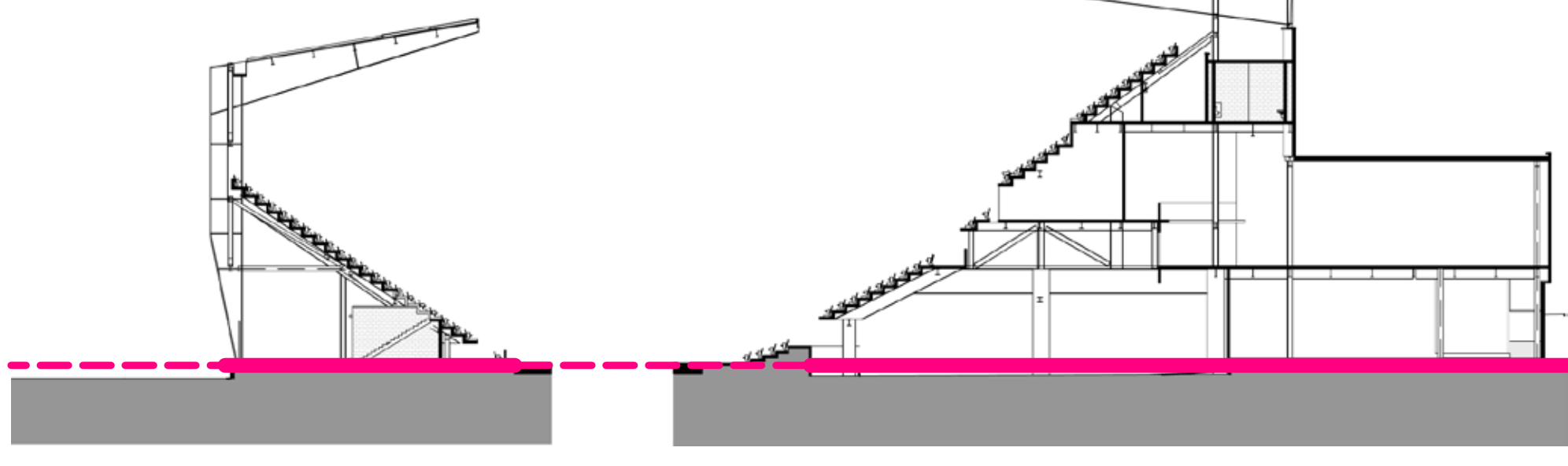

WEST SECTION

EAST SECTION

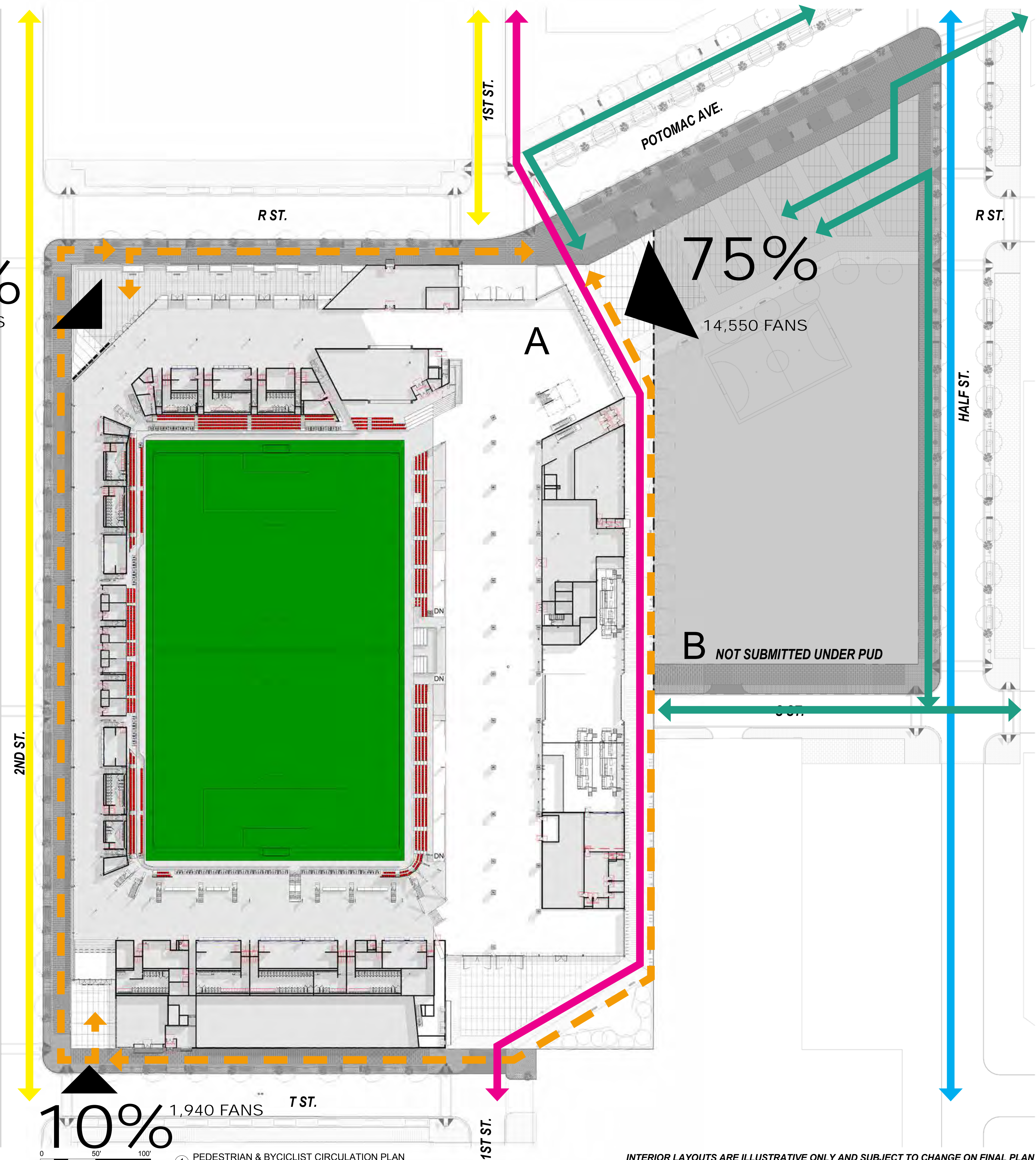

POPULOUS
Marshall | Moya Design



DC UNITED SOCCER STADIUM
100 Potomac Avenue, SW
Washington, DC 20024

100% PUD SUBMISSION

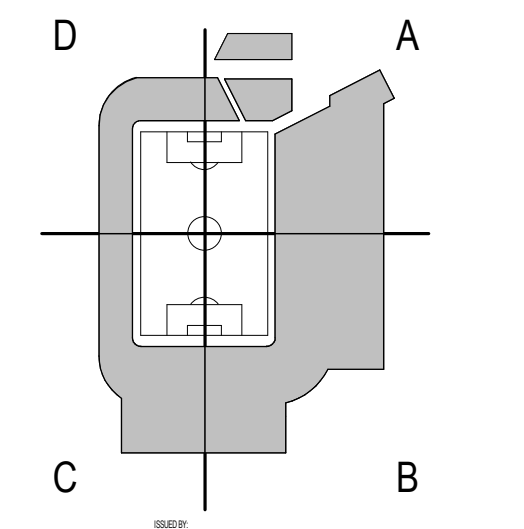







STADIUM SPECIFIC PEDESTRIAN AND BICYCLIST CIRCULATION PLAN

1.24

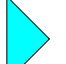
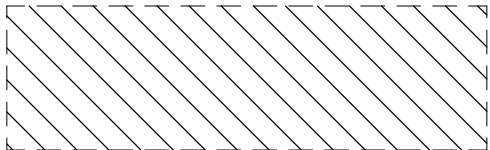
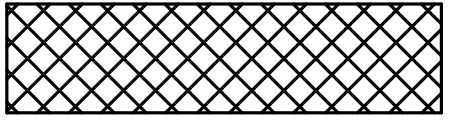
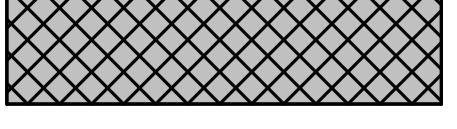

INTERIOR LAYOUTS ARE ILLUSTRATIVE ONLY AND SUBJECT TO CHANGE ON FINAL PLAN

- PEDESTRIAN - GAME DAY FAN ENTRANCE 
- PEDESTRIAN - STAFF / OFFICE / RETAIL ENTRANCE 
- PEPCO EASEMENT ENTRANCE 
- SERVICE / LOADING ENTRANCE 
- VEHICULAR ENTRANCE 
- TEMP TV TRUCK PARKING 
- TRASH COMPACTOR YARD 
- TRUCK MARSHALLING PLATFORM 
- PART B - NOT PART OF STADIUM PUD SUBMISSION, DESIGN INTENT SHOWN FOR REFERENCE ONLY 
- PUBLIC REALM - NOT PART OF PUD SUBMISSION, DESIGN INTENT SHOWN FOR REFERENCE ONLY 
- DISTRICT OF COLUMBIA RESPONSIBLE FOR DESIGN OF PUBLIC REALM

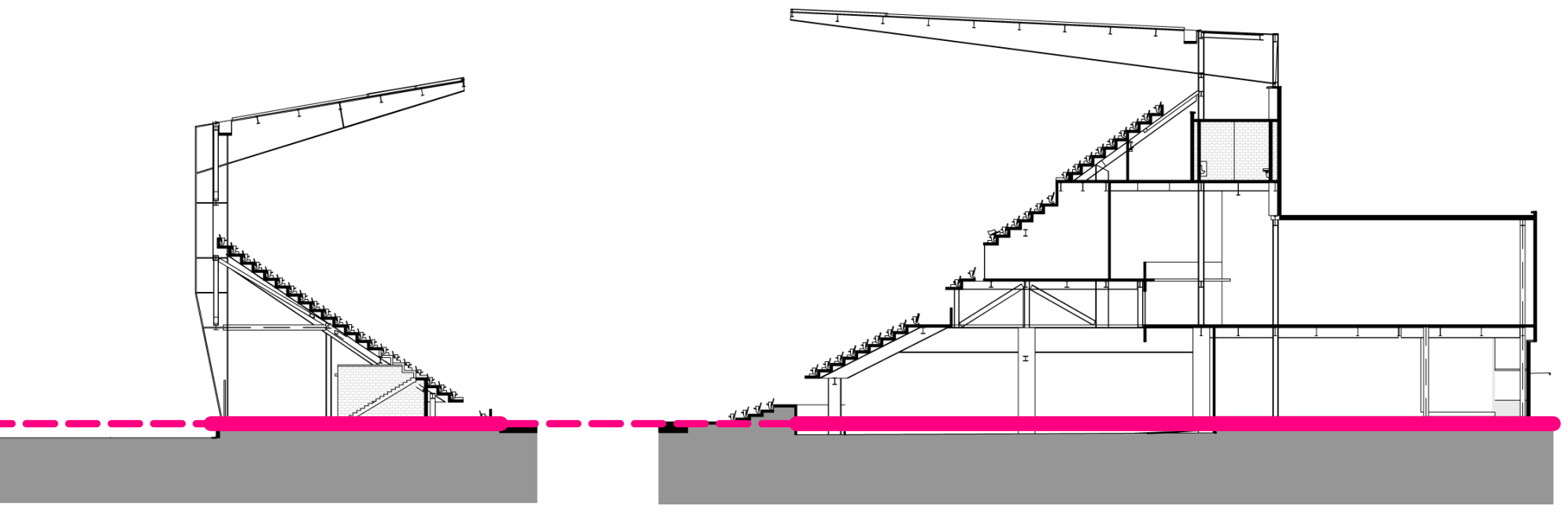
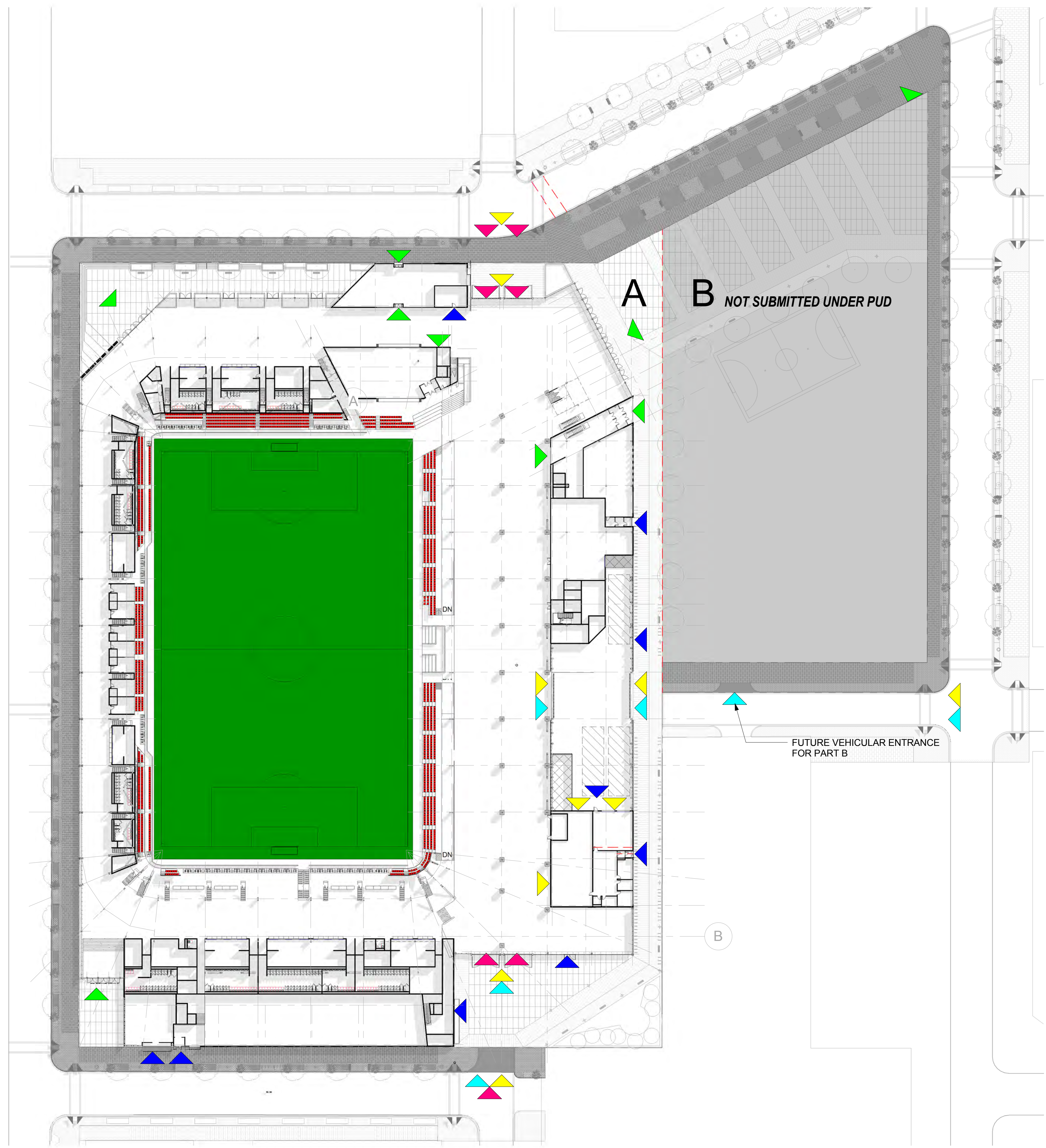

POPULOUS
Marshall | Moya Design



DC UNITED SOCCER STADIUM
100 Potomac Avenue, SW
Washington, DC 20024

100% PUD SUBMISSION

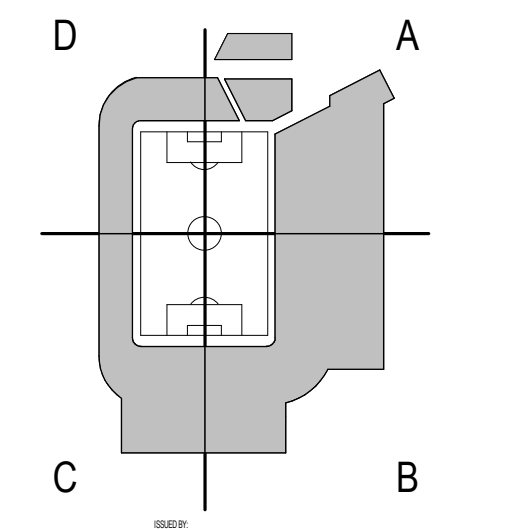

CIRCULATION AND LOADING PLAN

1.25

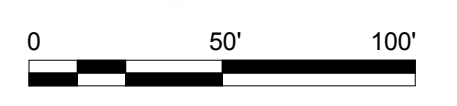

1 CIRCULATION AND LOADING PLAN
1" = 50'-0"

INTERIOR LAYOUTS ARE ILLUSTRATIVE ONLY AND SUBJECT TO CHANGE ON FINAL PLAN